

NEW!

HD ULTRA MFP



HD ULTRA i4220S MFP



SD 4400 MFP



SD 3600 MFP



XD 2400 MFP



Add a Contex scanner to any printer for a powerful, versatile, high quality MFP solution

Multi-function printers (MFPs) are compact and convenient, but often limited in features and capabilities. A Contex MFP solution lets you add a Contex scanner to any wide-format printer for an MFP with more powerful features, better image quality and unmatched versatility.

The smart way to MFP convenience

If your business is like most, you're probably being asked to hold back on new equipment purchases and squeeze more value out of what you already own. That's why built-in MFPs are not always the smartest choice today. These units are costly, and they often come with limited features, quality and flexibility. And when you buy one, you're also paying for expensive printer functionality you might already own.

An MFP solution from Contex can turn any new or existing printer into a copier, giving you the small footprint you need without compromising on performance and versatility. We've got an MFP solution for any environment—from occasional walk-up copying, printing and scanning in the office, to high-volume operator-driven services in reprographics departments, copy shops and printing and scanning service centers.

Big performance, small footprint

A Contex MFP solution gives you intuitive, powerful walk-up scanning and copying without taking up any more floor space than your existing printer. You get outstanding image quality, with real-time view of enhancements and automatic cleanup of faded, dirty, or poorly shaded documents.

Easy to use for any office worker

An intuitive touch-screen interface, auto-naming templates and convenient presets make our MFP solutions easy to use, with no special training needed. And built-in workgroup collaboration capabilities mean anyone can scan to email, scan to folder, and share the scanner with others on your LAN.

Productivity powerhouse

With simultaneous printing/copying while scanning, batch scanning, high scanning speeds, distributed copying and scanning to multiple printers, your Contex MFP solution will accelerate your processes. It will also help you streamline workflows with one-touch buttons and sharing over the network. For improved flexibility, you can exchange printers, work with different file formats and scan, copy and print any document. It even comes with a smart accounting feature that keeps track of billable services.

2 SOLUTION TYPES

Our two flexible MFP solution types make sure you'll find a setup that fits your situation exactly.

MFP Solution: Just add a printer

A scanner/software/touch screen/stand solution that connects to any printer, saving you space, giving you access to more formats, and letting you share your scanner on the network. The bundle includes a scanner, Nextimage software, touch screen, and high stand.

XD 2490, SD 3615, SD 4420 (24", 36", 44") with Nextimage MFP software are ideal for technical drawings, blue prints and maps.

The **HD Ultra i4220S** (42") is for every type of document, with superb image quality even when scanning thick, fragile and folded materials. The HD Ultra i4220S MFP comes with Nextimage Repro software.

MFP Kit: Choose your scanner

A complete software/touch screen/stand solution for your choice of scanner. Gives you versatility, image quality, more scanning power, full-featured image enhancement control and an ultra-productive archival and copying/printing system. You get a Contex high stand, our Nextimage Repro software with full imaging capabilities, and a Contex touch screen. Compatible with XD2490, SD3600, SD4400 or HD Ultra scanners.

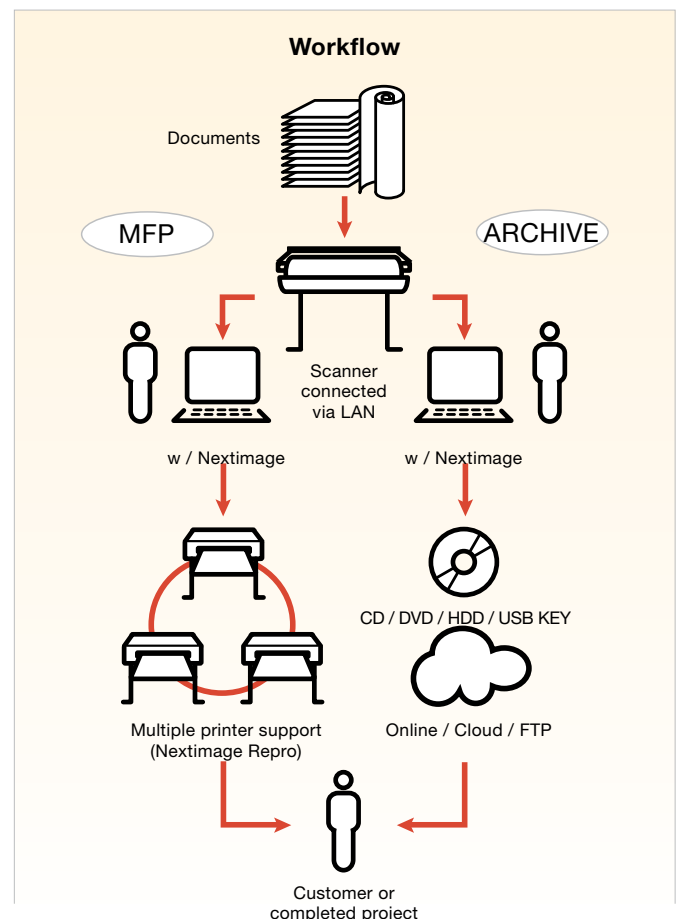



XD2490 MFP



SD3615 MFP



SD4420 MFP



HD Ultra i4220S MFP

Choose this affordable MFP solution as your daily tool for copying office graphics and documents. Perfect for small offices or businesses where traditional large-format copy solutions are too expensive or too large.

Get full color on-demand scanning, copying, emailing or printing in seconds. Easy plug-and-play operation and connectivity lets you do more with your existing equipment.

Leverage your existing printers and other office equipment with a 44" color scanner, intuitive touch screen, plug-and-play operation multi-function features that are easy to use and help everyone in your office work better together.

Copy, Scan, Print or Share any document - thick, curled, folded, fragile - in superb image quality and without compromising ease of use for any office worker. Features FlexFeed, SnapSize and more.

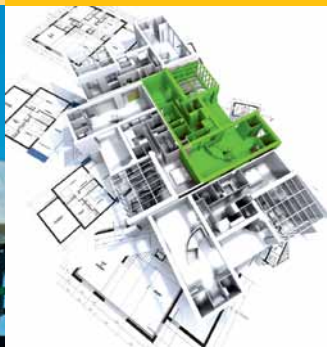

The Contex MFP solutions come with various stand heights to match your printer

Maximum supported printer heights • inches (mm)

	LOW	MEDIUM	HIGH
XD 2400	41.3 inch (1050 mm)		42.9 inch (1090 mm)
SD 4400	41.3 inch (1050 mm)		42.9 inch (1090 mm)
SD 3600	41.9 inch (1065 mm)	45.2 inch (1147 mm)	48.1 inch (1222 mm)
HD Ultra	42.3 inch (1075 mm)	45.3 inch (1150 mm)	48.2 inch (1225 mm)

Contex Nextimage enhancement software

Nextimage MFP

Comes with XD2490, SD3615 MFP and SD4420 MFP

Touch-screen mode
Basic Scan Functions
Batch scanning

TIF, JPG, PDF file formats

Basic Copy Functions
Supports one USB printer

Closed loop color calibration

Basic Image Adjustments

Black/White level adjustment

Nextimage Repro

Comes with HD Ultra i4220S MFP and MFP Kits

Touch-screen mode
Full Scan Function
Batch scanning
Multi-page PDF, TIF files
Job-accounting, scan-tracking
TIF, JPG, PDF, DWF, CALS, BMP, JPEG-2000(JP2), JPEG2000 Extended(JPX), TIF-G3, TIF-G4, others
Automatic file naming templates
Customize/Edit index color palette
Full Copy Functions
Supports unlimited printers
Batch copy
Closed loop color calibration
ICC color management
Full Image Adjustment control
Auto-rotate
Auto-align / deskew
Sharpen/Smoothen filter
Black/White level adjustment
RGB level adjustments
Histogram view
Measurement tool

About Contex

As the world's largest developer and producer of wide format imaging solutions, Contex leads the market with innovative technology and advanced scan and copy software solutions. Sold worldwide in over 80 countries, Contex solutions are recognized in a wide range of industries for reliability, value, high performance, and superb image quality.

As the global leader, we are always striving to deliver excellent service, superior products and great value to our partners and customers.

Looking Ahead

Contex's research and development work and dedication to our customers have made us a leader in the large format scanning industry, and we will continue to devote ourselves to R&D and market growth in the years to come.

We are confident in our work and our ability to establish strong, enduring relationships with our customers and partners well into the future.

Product range

HD ULTRA



– ultimate image quality
Boost productivity and get the ultimate in image quality. Encompassing the latest technologies, the versatile HD Ultra keeps your business running at full capacity.

FUJIFILM

Contex HD scanners use high quality lenses from Fujifilm.

SD SERIES



– your office workhorse
Scan, copy and share wide-format maps and drawings, with this reliable, easy-to-use office scanner.

XD SERIES



– affordable and portable
A durable, yet lightweight design makes the XD Series ideal for projects on the move, while still handling up to D or A1-sized documents.

MFP SERIES



– turn printers into copiers
Based on our HD Ultra, SD, or XD scanners, these space-saving, plug-and-play solutions come with touch-enabled screen and software for ease of use.

NEXTIMAGE

You can copy, print, email, edit, and scan with Nextimage multi-function wide format software. Just one user-friendly interface, creating the perfect link between your scanner, digital storage, existing software, and printers.

ISIS and TWAIN Drivers

The Contex ISIS driver lets you scan large format documents directly into your electronic document/content management workflow.

TWAIN lets you import images into your other software applications, including Adobe Photoshop, Microsoft Office, Autodesk and EDM solutions.

Industries

We know that requirements vary depending on the types of documents you work with, so we've made sure you can find the right combination of speed, resolution and operational simplicity in our range of solutions, including scan-to-file, scan-to-print and multi-function capabilities. Contex solutions are ideal for processing CAD drawings, plans, blueprints, maps, posters, artwork and many other types of documents.

Technical documents

- Government
- Architecture
- Engineering
- Construction
- Manufacturing
- Utilities

GIS & mapping documents

- Civil Engineering
- Surveying
- Facility management
- Natural Resources
- Utilities
- Government

Graphic documents

- Graphic Arts
- Photography
- Publishing
- Signs

All document types

- Copy Shop
- Reprographics
- Printing and Document Services

Other documents

No matter what it is – textile patterns, legal documents or other specialized media – our solutions handle them with care and create perfect reproductions.

Locations

Head Office

Contex A/S
2 Svanevang
DK-3450 Allerød
Denmark
Phone: +45 4814 1122
Fax: +45 4814 0122
info@contex.com

EMEA & AP Branch Office

Contex A/S
Allerød, Denmark
Phone: +45 4814 1122
emea-ap@contex.com

Contex Singapore Pte.Ltd.
Phone: +65 68 538 135
emea-ap@contex.com

Americas Branch Office

Maryland, USA
Toll Free: +877-226-6839
(877-2-CONTEX)
Phone: +1 (703) 964 9850
Fax: +1 (703) 547 3375
SalesAmericas@contex.com

China Branch Office

Shanghai, China
Phone: +86 21 6422 2525
info-china@contex.com

Japan Branch Office

Contex
Scanning Technology Japan A/S
1-10-2F Nihonbashi Kabuto-Cho,
Chuo-Ku 103-0026 Tokyo
Japan
Phone: +81 3 3669 5515
Fax: +81 3 3669 5516
info-japan@contex.com

www.contex.com



Read more at contex.com

